



## Caster Wheel Update Kit 3P806NT and 3P1006NT Drills

Used with:

- 3P806NT (S/N A1034V-)
- 3P1006NT (S/N A1047-)



*When you see this symbol, the subsequent instructions and warnings are serious - follow without exception. Your life and the lives of others depend on it!*

## General Information

These instructions explain how to install a Caster Wheel Update Kit. One kit updates an entire drill:

Kit	Kit Description
124-047A	Caster Wheel Update Kit

## Related Documents

Have the Operator and Parts Manuals at hand.

151-143M	Operator, 3P806NT
151-143P	Parts, 3P806NT
151-144M	Operator, 3P1006NT
151-144P	Parts, 3P1006NT

## Tools Required

- basic hand tools
- grease and grease gun

## Work Location

1. Move the implement to a location with:
  - flat, smooth surface
  - adequate illumination

## Prepare Drill

2. Block the tires and install the parking jack.
3. Disconnect all hydraulic and electrical connections at the hitch. Secure hoses and cables to prevent ground contact.

## Notations and Conventions

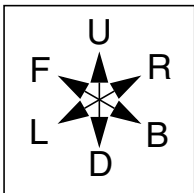

“Left” and “Right” are facing in the direction of machine travel. An orientation rose in the line art illustrations shows the directions of Left, Right, Front, Back, Up, Down.

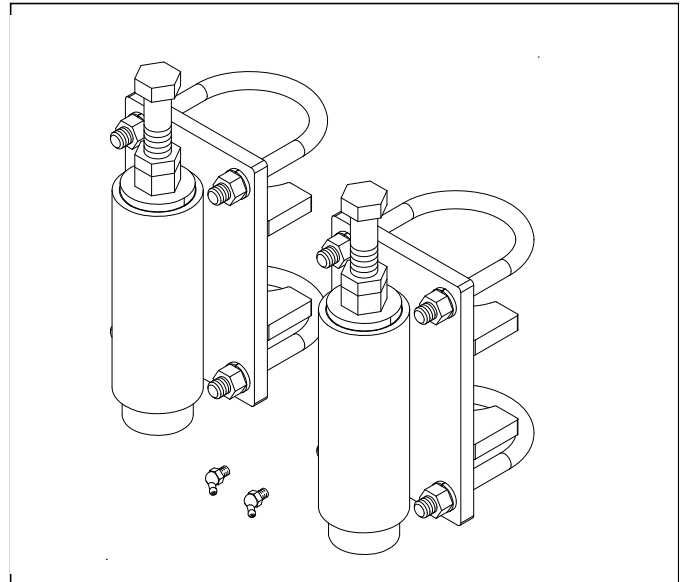

Figure 1  
Caster Wheel Update Kit

29969

## WARNING

**High Pressure Fluid Hazard:**  
*Relieve pressure from all lines before working on hydraulic connections. Wear eye protection and gloves when opening hydraulic connections. Open connections slowly. Use a piece of paper or cardboard, NOT BODY PARTS, to check for leaks. Escaping fluid under pressure can have sufficient pressure to penetrate the skin causing serious injury. If an accident occurs, seek immediate medical assistance from a physician familiar with this type of injury.*



## Call-Outs

- ① to ⑨ Single-digit callouts identify components in the currently referenced Figure. These numbers may be reused for different items from page to page.
- ⑪ to ⑳ Two-digit callouts in the range 11 to 21 reference new parts from the list on page 4.
- ⑤① This callout references an existing part from page 4.

# Caster Wheel Update

## Installation

### Refer to Figure 2

These instructions are for both caster wheels.

1. Remove existing straight grease zerk from lift assist arm.
2. Replace with 90 degree zerk from kit:  
 (15) 800-073C GREASE ZERK 1/4-28 X 90-DEG
3. Using grease gun apply one or two shots of grease to zerk.
4. Select one each:  
 (13) 266-012D PLATE RND 3/16" THK 1 7/8"  
 (21) 807-143C SPRING COMP 1.88OD X .362W  
 (14) 266-020D UHMW RND 2.0 DIA X 2.0 LONG  
 Install in bottom of caster disk weldmount  
 (12) 124-048H CASTER DISC MOUNT.
5. Leaving room for grease zerk maintenance, rotate assembly to the left and install on lift assist arm.

Select two:

(20) 806-217C U-BOLT ROUND 1/2-13 X 3 9/3

Select four washers and nuts:

(19) 804-015C WASHER LOCK SPRING 1/2 PLT

(17) 803-020C NUT HEX 1/2-13 PLT

6. Select one bolt and nut:

(18) 803-048C NUT HEX JAM 3/4-10 PLT

(16) 802-067C HHCS 3/4-10X4 GR5 FTHD

Install in top of caster disk mount.

7. Repeat steps 1 through 7 for opposite caster wheel.

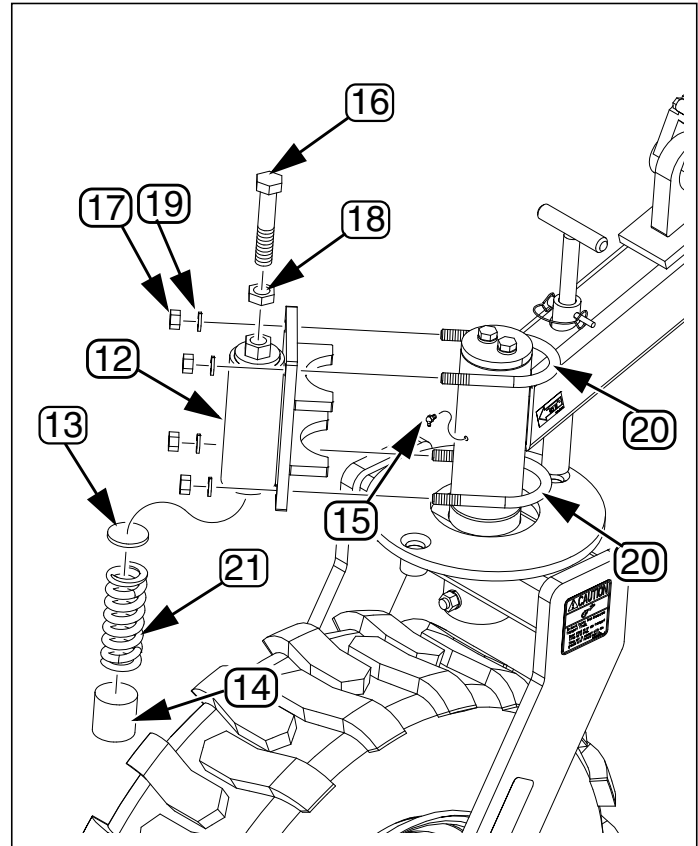

Figure 2  
Caster Disk Mount

29968

## Final Adjustments

The function of this new drill feature is to dampen caster motion. This avoids oscillation in transport and possible furrow damage in the field.

*Refer to Figure 3*

### Initial Adjustment

The initial adjustment should be about 1½ inches from the bracket base to bolt head top.

### Field and Road Adjustments

Check castering in both field and road transport. Adjust as needed.

The caster brake may need to be adjusted as field and road conditions vary. Factors affecting the caster brake adjustment include: field residue, no-till or min-till conditions and moisture.

### Check Adjustments

It may also be necessary to adjust when switching from field to road transport or vice versa.

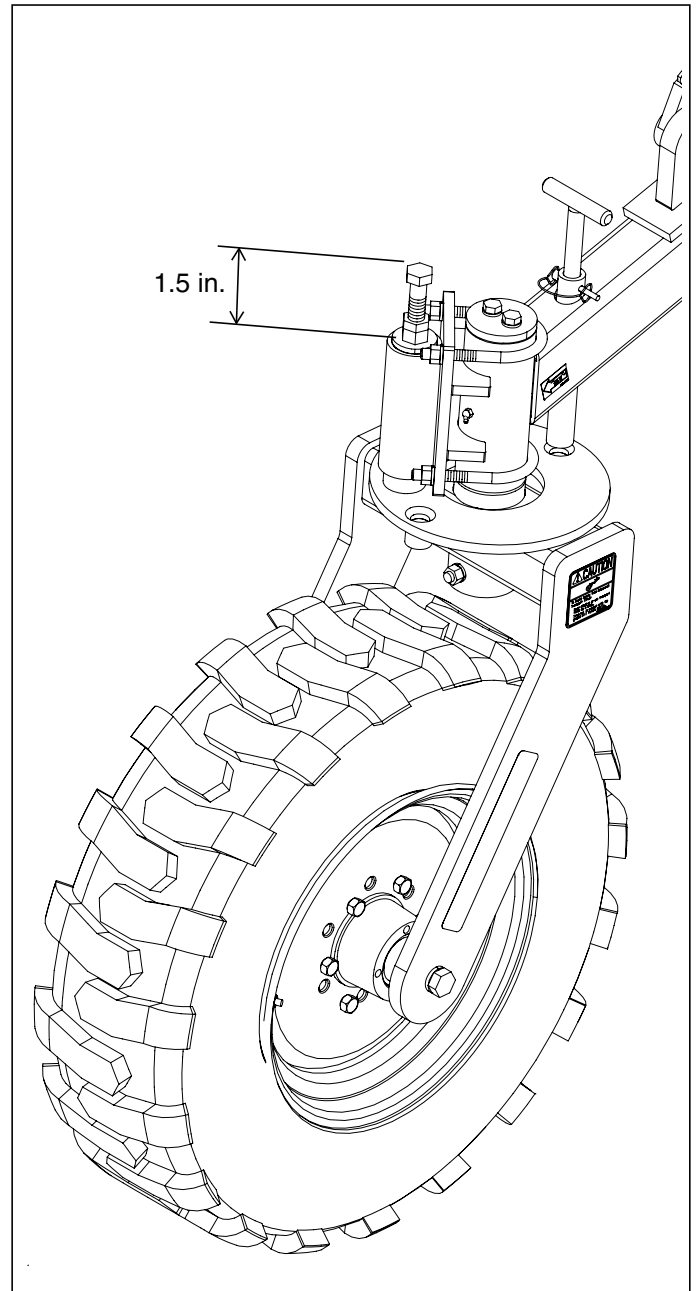

Figure 3  
Final Caster Brake Adjustments

29967

## Appendix

### Part Lists

#### New Parts

The part call-out numbers in this list match all Figures in these installation instructions. Part descriptions match those in your updated Parts Manual.

Quantities are units ("ea").

#### Kit Contents

124-047A Caster Wheel Update Kit

Callout	Quantity	Part Number	Part Description
11	1	124-049M	MANUAL CASTER DISC MOUNT
12	2	124-048H	CASTER DISC MOUNT
13	2	266-012D	PLATE RND 3/16" THK 1 7/8"
14	2	266-020D	UHMW RND 2.0 DIA X 2.0 LONG
15	2	800-073C	GREASE ZERK 1/4-28 X 90-DEG
16	2	802-067C	HHCS 3/4-10X4 GR5 FTHD
17	8	803-020C	NUT HEX 1/2-13 PLT
18	2	803-048C	NUT HEX JAM 3/4-10 PLT
19	8	804-015C	WASHER LOCK SPRING 1/2 PLT
20	4	806-217C	U-BOLT ROUND 1/2-13 X 3 9/3
21	2	807-143C	SPRING COMP 1.88OD X .362W

#### Existing Parts Affected

The following existing parts are involved in the kit installation. The Disposition column indicates whether the part is left in place, moved or not re-used.

The part call-out numbers in the list matches all Figures in the installation instructions. The descriptions match those in your implement Parts manual.

Callout	Part No.	Part Description	Part Disposition
51	800-001C	GREASE ZERK STRAIGHT 1/4-28	Removed. Not reused.

#### Abbreviations

3P, 3-PT	Three Point (hitch)
DEG	Degree
DIA	Diameter
F/	For
FTHD	Full Thread
GR5	Grade 5
HEX	Hexagonal (6-sided)
HH	Hydraulic Hose
HHCS	Hex Head Cap Screw (Bolt)
JIC	Joint Industry Conference (Fitting)

NT	No-Till
OD	Outside Diameter
PLT	Plated
RND	Round
THK	Thick
UHMW	Ultra High Molecular Weight
W	Wide/Width
W/	With
X	by

### Great Plains Manufacturing, Inc.

Corporate Office P.O. Box 5060  
Salina, Kansas 67402-5060 USA